

# Air Headers

## AP1 Series

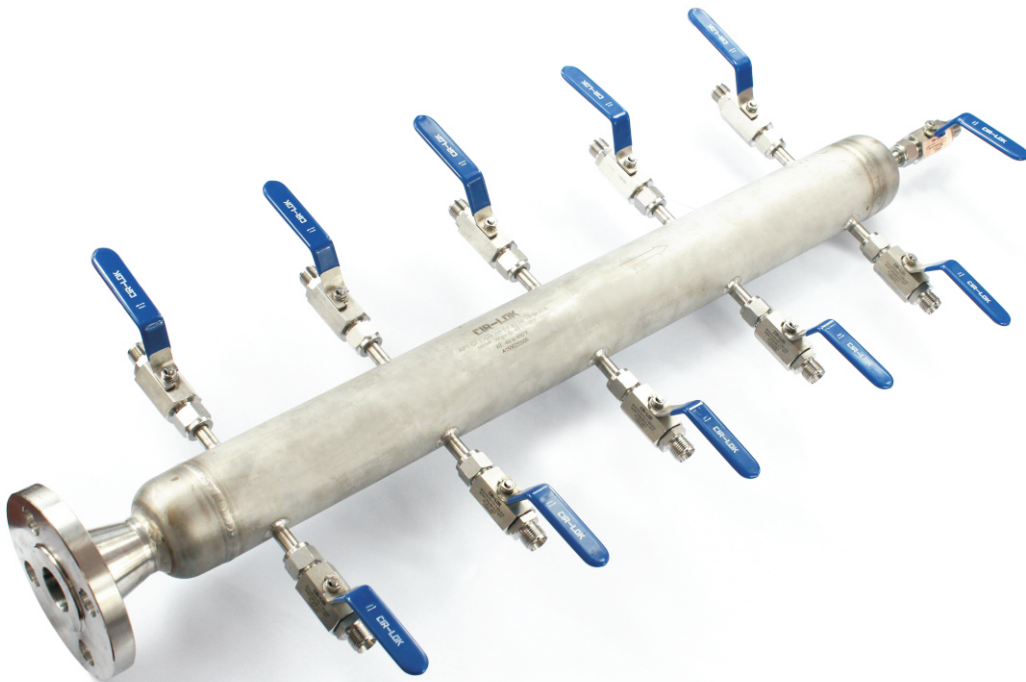

- ❖ Working pressure up to 300 psig (20.6 bar)
- ❖ Working temperatures from -40°F to 450°F (-40°C to 232°C)
- ❖ Inlet Connection: flange, threaded welded
- ❖ Drain Connection: ball valves, needle valves, CIR-LOK tube fittings threaded
- ❖ Red, Yellow, and blue handles are available

## Features

- ❖ Working pressure up to 300 psig (20.6 bar)
- ❖ Working temperatures from -40°F to 450°F (-40°C to 232°C)
- ❖ Red, Yellow, and blue handles are available
- ❖ The standard main line is Sch 40 pipe
- ❖ Distribution ports are BV3 or BV5 Series ball valves

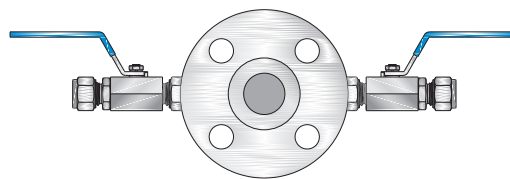

## Standard Materials of Construction

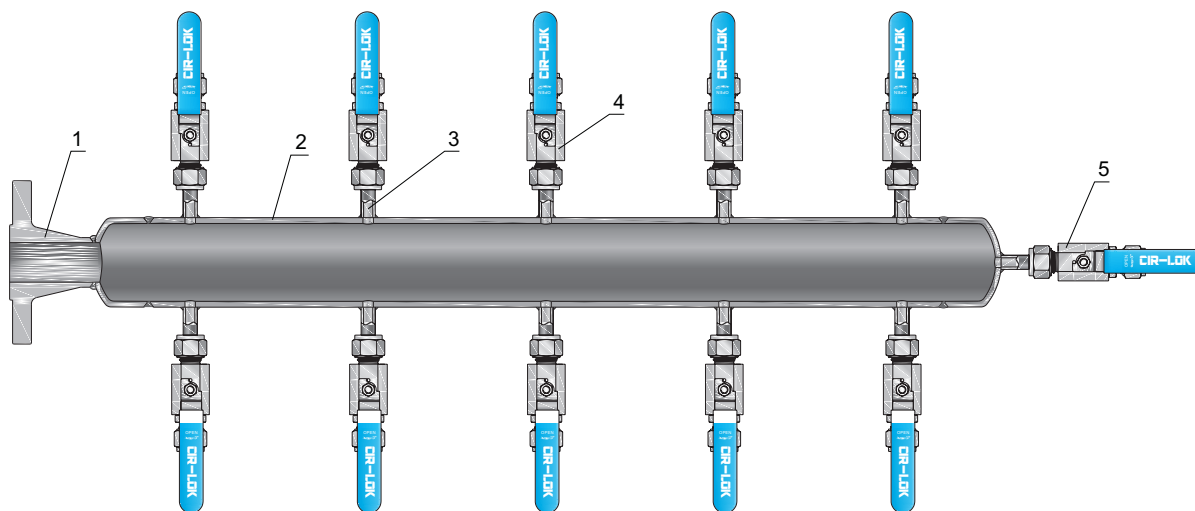

Item	Component	Material/ASTM Specification
1	Inlet Valve	BV5 Series Ball Valve
	Flange	F316 S.S./A182
2	Main Line	316 S.S./A312
3	Branch Fitting	316 S.S./A276
4	Distribution Valve	BV3 series ball valve as standard option
5	Drain Valve	BV3 series ball valve as standard option
	Plug	316 S.S./A276

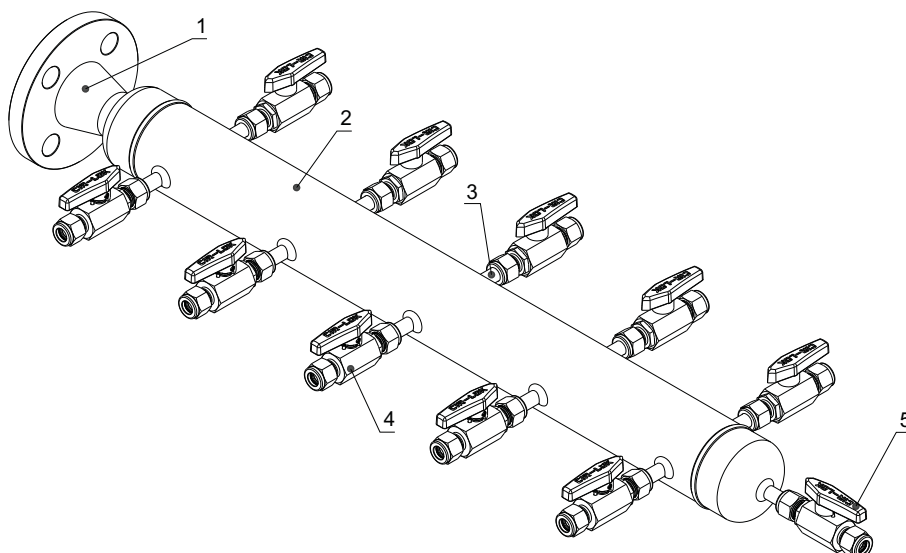

## End Connections

Connection	Type	Size	Standard
Inlet Connection	Pipe Butt Welded	3/4, 1, 1 1/2, 2, 2 1/2, 3, 4	ASME 16.25
	Pipe Socket Welded		ASME 16.11
	Female NPT		ASME B 1.20.1
	Female BSP Tapered		ISO 7/1, DIN 2999
	Female BSP Parallel		ISO 228-1, DIN 3852
	Flange	DN20, DN25, DN32, DN40, DN50, DN65, DN80	ANSI B 16.5
Outlet Connection	Female NPT	1/4, 3/8, 1/2, 3/4, 1	ASME B 1.20.1
	Male NPT		ISO 7/1, DIN 2999
	Female BSP Tapered		
	Male BSP Tapered		
	Female BSP Parallel		ISO 228-1, DIN 3852
	Male BSP Parallel		
	Female ISO 261	M6 x 1, M10 x 1, M12 x 1.5, M14 x 1.5,	ISO 261
	Male ISO 261	M16 x 1.5, M20 x 1.5, M24 x 1.5, M27 x 2	
	Fractional Tube Fitting		CIR-LOK Tube Fitting
	Nut+Gasket+Fractional bulge Nipple	1/4, 5/16, 3/8, 1/2, 5/8, 3/4, 1, 1 1/4	—
Nut+Gasket+Metric Bulge Nipple	6 mm, 8 mm, 10 mm, 12 mm, 14 mm, 16 mm, 18 mm, 20 mm, 22 mm, 25 mm	—	
Metric Tube Fitting		CIR-LOK Tube Fitting	
Drain Connection	Female NPT	1/2, 3/4, 1	ASME B 1.20.1
	Male NPT		ISO 7/1, DIN 2999
	Female BSP Tapered		
	Male BSP Tapered		
	Female BSP Parallel		ISO 228-1, DIN 3852
	Male BSP Parallel		
	Female ISO 261	M10 x 1, M16 x 1.5, M20 x 1.5, M24 x 1.5	ISO 261
	Male ISO 261		
	Fractional Tube Fitting	1/2, 3/4, 1	CIR-LOK Tube Fitting
Metric Tube Fitting	10 mm, 14 mm, 20 mm, 25 mm		

CIR-LOK Air Headers are used to supply users with instrument air. Besides multiple types of standard styles we also supply the Air Headers according to customer demands.

## Optimized Setting of the Main Pipe and the Branch

Main Line Size (Sch 40)	Outlet End Connection		Quantity of Distribution Valve
	Tube		
	Fractional in.	Metric mm	
3/4	3/8	8, 10	6 to 8
	1/2	12	4
	1/4	6	10 to 16
1	3/8	8, 10	10 to 14
	—	12	6 to 8
	1/4	6	18 to 24
	1/2	—	6
	—	—	—
1 1/4	3/8	8, 10	16 to 24
	—	12	10 to 12
	5/8	14, 16	4 to 6
	1/4	6	28 to 48
	1/2	—	8 to 10
1 1/2	3/8	8, 10	28 to 36
	—	12	16 to 20
	5/8	14, 16	8 to 10
	3/4	18, 20	4 to 6
	1/2	—	12 to 16
2	—	12	24 to 32
	5/8	14, 16	12 to 16
	3/4	18, 20	8 to 10
2 1/2	1	22, 25	4 to 6
	1/2	—	18 to 24
	5/8	14, 16	18 to 24
	3/4	18, 20	12
3	1	22, 25	8
	1 1/4	28	4
	1/2	—	26 to 38
	5/8	14, 16	26 to 38
	3/4	18, 20	16 to 24
4	1	22, 25	10 to 12
	1 1/4	—	6 to 8
	3/4	18, 20	28 to 40
	1	22, 25	16 to 24
	1 1/4	—	10 to 12

# How to Order

API — **FNPT16N** — **16FNPT8V** — **AFNPT8** — **Y** — **316**

Series	Inlet Type	Inlet Size	Inlet Valve	Outlet Quantity	Outlet Type	Outlet Size	Outlet Valve/Plug	Drain	Drain Type	Drain Size	Handle	Body Material
AP1	FNPT Female NPT	12 3/4	N No	4	FNPT Female NPT	8 1/2 in. or 8 mm	V Valve	A Valve with Plug	FNPT Female NPT	None	Blue	316 316 S.S.
	FBT Female BSPT	16 1	Y Yes	6	NPT Male NPT	M10 x 1 or 10mm	P Plug	V Valve	NPT Male NPT	1/2 in. or 8 mm	Y Yellow	304 304 S.S.
	FBP Female BSPP	24 1 1/2		8	FBT Female BSPT	3/4 in. or 12 mm	N No	P Plug	FBT Female BSPT	M10 x 1 or 10mm	R Red	
	PSW Pipe Socket Weld			10	MBT Male BSPT	M14 x 15 or 14 mm			MBT Male BSPT	3/4 in. or 12 mm	L Black	
	PBW Pipe Butt Weld			12	FMS Female Metric				FMS Female Metric	M14 x 15 or 14 mm		
	RF1 Serrated Flange (ASME B 16.5)			.	MS Male Metric				MS Male Metric			
	RF3 Serrated Flange (ASME B 16.5)			.	FBP Female BSPP				FBP Female BSPP			
				.	MBP Male BSPP				MBP Male BSPP			
				.	F Fractional Tube Fitting				F Fractional Tube Fitting			
				.	M Metric Tube Fitting Handle				M Metric Tube Fitting Handle			
				.	UGM Nut + Gasket + Bulge Nipple							