



Bellows Valves

1000 psig (68.9 bar), 700 psig (48.2 bar)
VUBF, VUBFD, VUBFH, VUBFN Series



Administrative Offices**Corporate Headquarter**

Kita Hankyu Bldg., 1-4-8 Shibata, Kita-ku, Osaka 530-0012, Japan
Tel: +81-6-6372-7141, +81-50-3160-7141 (IP) Fax: +81-6-6375-0697

Production Centers**Osaka Plant**

3-9-21 Nagata, Higashi-Osaka, Osaka 577-0015, Japan
Tel: +81-6-6787-2201, Fax: +81-6-6787-1611

Osaka Kashiwara Enterprise

1000-45 Enmyo-cho, Kashiwara, Osaka 582-0027, Japan
Tel: +81-72-977-4661, Fax: +81-72-977-5549

Tsukuba Research Plant

18 Miyukigaoka, Tsukuba, Ibaraki 305-0841, Japan
Tel: +81-29-856-3301, Fax: +81-29-856-3889

Sales and Support Centers**Corporate Headquarter****International Business Offices**

Kita Hankyu Bldg., 1-4-8 Shibata, Kita-ku, Osaka 530-0012, Japan
Tel: +81-6-6372-7141, +81-50-3160-7141 (IP) Fax: +81-6-6375-0697

New Headquarter**International Business Offices**

Akihara Dai Bldg., 1-18-13 Sotokanda, Chiyoda-ku, Tokyo 101-0021, Japan
Tel: +81-3-3252-0301, Fax: +81-3-5209-8835

China Service Center

Songhu Industry Minizoom, Songjiang High-Technology Park, Jiuting Zheng,
Songjiang, Shanghai, PRC
Tel: +86-21-6769-6576, Fax: +86-21-6769-6536

Overseas Subsidiaries**Fujikin of America Inc.****CA Office**

4677 Old Ironsides Dr., Suite #100, Santa Clara, CA 95054, USA
Tel: +1-408-980-8269, Fax: +1-408-980-0572

NJ Office

4 Alsan Way, Little Ferry, NJ 07643, USA
Tel: +1-201-641-1119, Fax: +1-201-641-1137

TX Office

2028 E. Ben White Blvd., Suite #320, Austin, TX 78741, USA
Tel: +1-512-912-9095, Fax: +1-512-912-8095

Carten Controls Ltd.

Unit 609, Northern Ext. Waterford Industrial Park, Waterford, Ireland
Tel: +353-51-355436, Fax: +353-51-378054

Fujikin Deutschland GmbH

Leopold Strasse 9, 40211 Düsseldorf, Germany
Tel: +49-211-350-458, Fax: +49-211-363-990

Fujikin Vietnam Co.,Ltd.

H-2B Plot, Thang Long Industrial Park Dong Anh Dist., Hanoi, Vietnam
Tel: +84-4-38812566, Fax: +84-4-38812577

Fujikin of China Inc.

Songhu Industry Minizoom, Songjiang High-Technology Park, Jiuting Zheng,
Songjiang, Shanghai, PRC
Tel: +86-21-6769-6576, Fax: +86-21-6769-6536

New Headquarter

Akihara Dai Bldg., 1-18-13 Sotokanda, Chiyoda-ku, Tokyo 101-0021, Japan
Tel: +81-3-3252-0301, Fax: +81-3-5209-8835

Tohoku Service Plant

11-31 Aza Sodeyama, Iwayadou, Esashi-ku, Oshu, Iwate 023-1101, Japan
Tel: +81-197-35-8701, +81-05-3161-0301 (IP), Fax: +81-197-35-8704

Osaka High-Tech Research and Creative Development Center

8-2-29 Nanko-Higashi, Suminoe-ku, Osaka 559-0031, Japan
Tel: +81-6-6612-0251, Fax: +81-6-6612-8541

US Connecticut Factory

604 West Johnson Avenue, Cheshire, CT 06410, USA
Tel: +1-203-699-2173 | Fax: +1-203-699-2179

Taiwan Service Center

3F-1, No. 32, Tai Yuen St., Chupei City, Hsinchu County 302, Taiwan, ROC
Tel: +886-3-5600300, Fax: +886-3-5600320

Korea Service Center

B-1306, Digital Empire, 980-3, Youngtong-dong, Youngtong-gu, Suwon-shi,
Gyeonggi-do, Korea
Tel: +82-31-303-2780, Fax: +82-31-303-2789

Fujikin of China Inc.**Beijing Office**

Rm. 1103A, Air China Plaza, No.36 Xiaoyun Road, Chaoyang District, Beijing,
PRC
Tel: +86-10-8447-5249, +86-10-8447-5269, Fax: +86-21-10-8447-5289

Fujikin Korea Inc.

B-1306, Digital Empire, 980-3, Youngtong-dong, Youngtong-gu, Suwon-shi,
Gyeonggi-do, Korea
Tel: +82-31-303-2780, Fax: +82-31-303-2789

TKSCT corporation

1579-1, Songjeong-dong, Gangseo-gu, Busan, Korea
Tel: +82-51-970-6700, Fax: +82-51-831-1215

Fujikin Taiwan Inc.

3F-1, No. 32, Tai Yuen St., Chupei City, Hsinchu County 302, Taiwan, ROC
Tel: +886-3-5600300, Fax: +886-3-5600320

Fujikin Singapore Pte.Ltd.

20 Jalan Afifi #06-01 Certis Cisco Center II Singapore 409179
Tel: +65-6848-5760, Fax: +65-6746-7021

IMPORTANT NOTICE:

The product data in this catalogue was obtained under specific test conditions that may vary substantially from actual site conditions and / or customer needs.

Purchasers or other end users of Fujikin[®] products should rely solely on their system design engineer(s) when selecting Fujikin[®] products for a particular system, and when determining the suitability of any system in which a Fujikin[®] product is to be installed.

Fujikin[®] shall bear no liability regarding product selection criteria or decisions, nor shall Fujikin[®] be liable (including direct, special or consequential damages including, but not limited to, lost profits or income) in regard to any product which has been damaged by misuse, improper handling or accident, or as a result of service or modification by anyone other than an authorized employee or agent of Fujikin[®], or being subjected to use under conditions, or combinations of conditions, that are not compatible with that particular Fujikin[®] product.

Beyond the Flow of Things

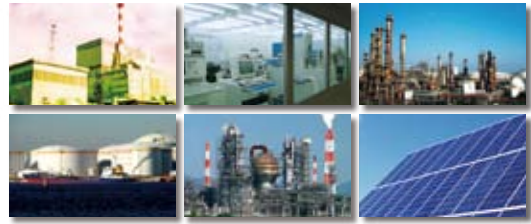

Fujikin provides you with a total solution for your flow control needs.



Weirless Diaphragm Valves
Weir Diaphragm Valves

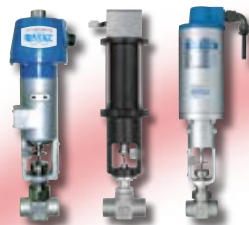

Electronic Control Valves

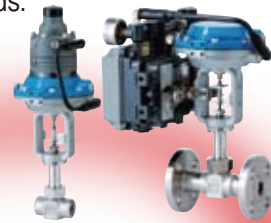

MINUCON[®]

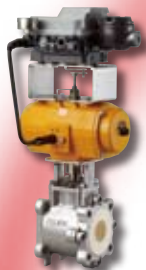

Fine Ceramic Ball Valves
COSMIX[™]



Integrated Gas System (IGS[®])



Flow Control System
FCS[®] Thermal Series



Static Mixer

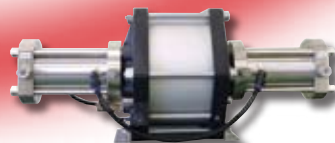

PROVIDER[®] POWER UNIT



Welding,
processing Machine

1000 psig (68.9 bar) Type (VUBF-96P, VUBFD-96P Type)

Features

1. Precision-formed metal bellows provides reliable seal to atmosphere.
2. Sealed between body and bellows by gasket.
3. A positive seal is repeatedly possible with nonrotating spherical disk.
(Metal Seal Type, Soft Seal Type)
4. Panel and bottom mounting.
5. End Connections: ∇ ® - Lok 6.35, 9.52, 12.7



Metal Seal Type (VUBF-96P Type)

Technical Data

Temperature and Pressure Rating

Size	6.35	9.52	12.7
Temperature °F (°C)	- 20 (- 28) ~ 600 (315)		
Working Pressure [psig (bar)]	1000 (68.9)		

Materials of Construction

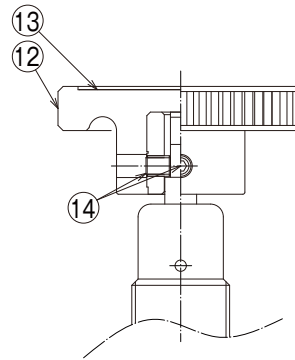
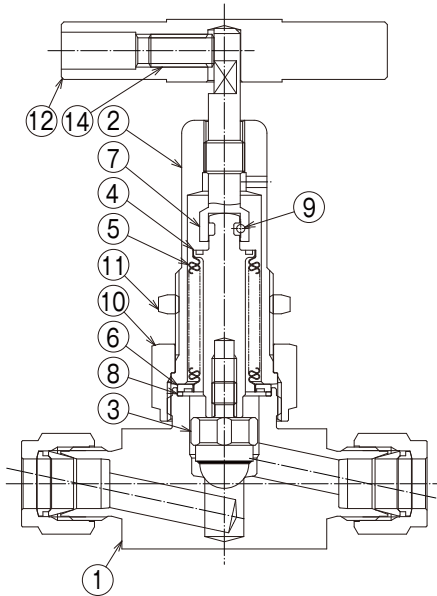

Construction of handle part (Size 6.35)

No.	Description	Materials	No.	Description	Materials
1	BODY ※	ASTM A479 316	9	STOP PIN	SUS304
2	BONNET	ASTM A479 316	10	BONNET NUT	ASTM A479 316
3	DISK ※	COBALT - BASED ALLOY + ASTM A479 316	11	PANEL NUT	ASTM A276 316
4	STEM(1) ※	ASTM A479 316	12	HANDLE	Size 6.35: PHENOLIC RESIN + ZDC2
5	BELLOWS ※	ASTM A240 321			Size 9.52,12.7: ALUMINUM 2024-T4
6	WELD RING ※	ASTM A479 316	13	NAME PLATE(Size 6.35)	POLYESTER
7	STEM(2)	ASTM A582 416	14	SET SCREW	ANSI 18.3 ALLOY STEEL
8	GASKET ※	ASTM A580 316			

※ : Wetted Parts

Soft Seal Type (VUBFD-96P Type)

Technical Data

Temperature and Pressure Rating

Size	6.35	9.52	12.7
Temperature °F (°C)	- 20 (- 28) ~ 200 (93)		
Working Pressure [psig (bar)]	1000 (68.9)		

Materials of Construction

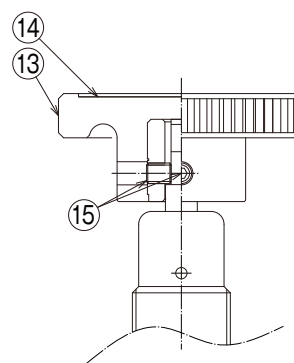
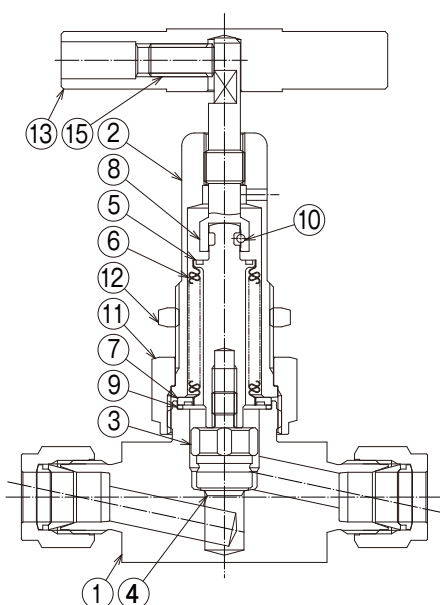

Construction of handle part (Size 6.35)

No.	Description	Materials	No.	Description	Materials
1	BODY ※	ASTM A479 316	9	GASKET ※	ASTM A580 316
2	BONNET	ASTM A479 316	10	STOP PIN	SUS304
3	DISK ※	ASTM A479 316	11	BONNET NUT	ASTM A479 316
4	DISK PACKING ※	PCTFE	12	PANEL NUT	ASTM A276 316
5	STEM(1) ※	ASTM A479 316	13	HANDLE	Size 6.35: PHENOLIC RESIN + ZDC2 Size 9.52, 12.7: ALUMINUM 2024-T4
6	BELLOWS ※	ASTM A420 321			
7	WELD RING ※	ASTM A479 316	14	NAME PLATE(Size 6.35)	POLYESTER
8	STEM(2)	ASTM A582 416	15	SET SCREW	ANSI 18.3 ALLOY STEEL

※ : Wetted Parts

Dimensions and Ordering Numbers

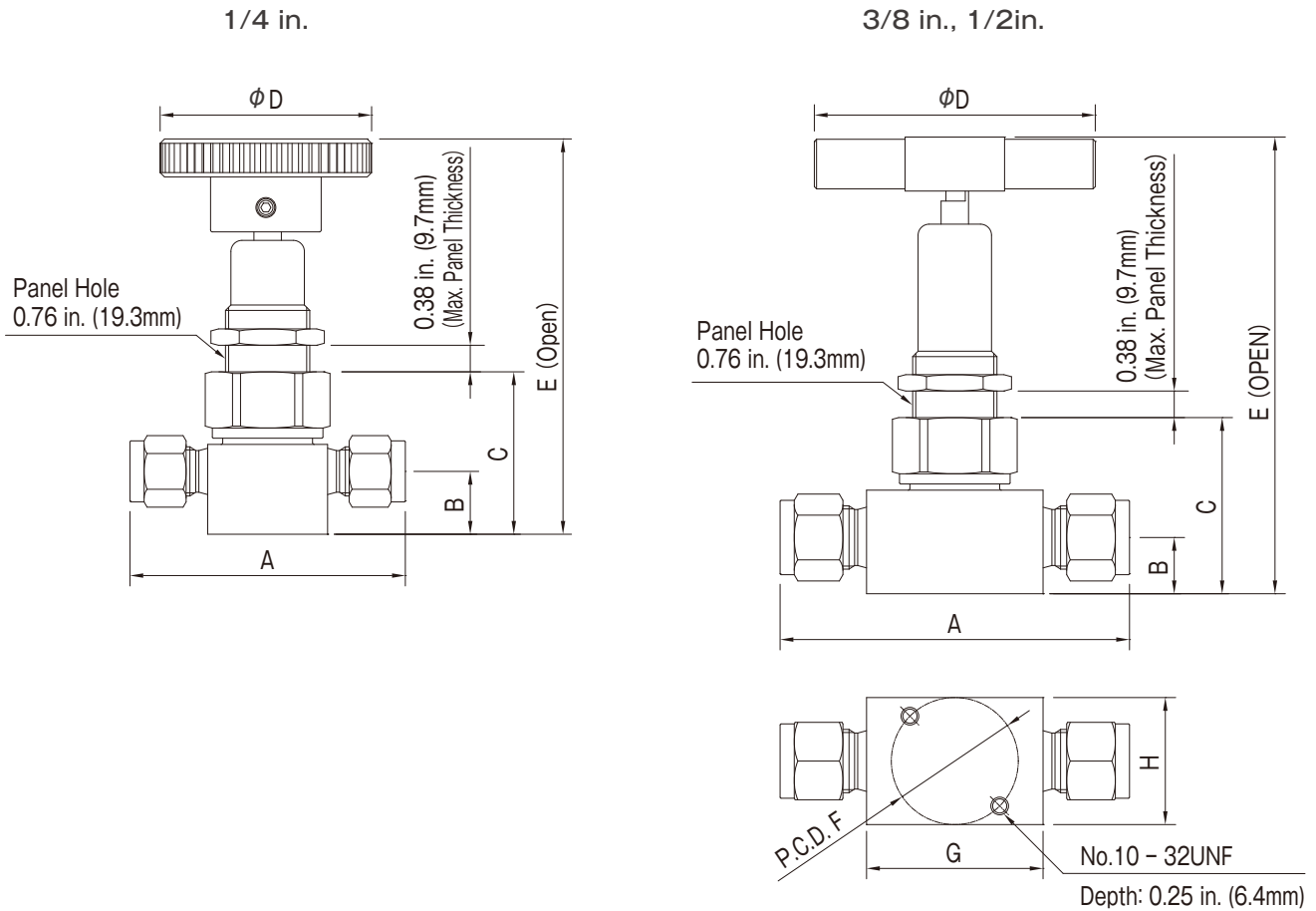

End Connections Inlet/Outlet	Size	Orifice in. (mm)	Dimensions in. (mm)								Ordering Numbers
			A	B	C	D	E	F	G	H	
V - Lok	1/4 in.	0.16 (4.1)	2.46 (62.5)	0.56 (14.2)	1.45 (36.8)	1.88 (47.8)	3.64 (92.5)	1 (25.4)	1.06 (26.9)	1 (25.4)	VUBF - 96P - 6.35 VUBFD - 96P - 6.35
	3/8 in.	0.3 (7.6)	3.09 (78.5)	0.5 (12.7)	1.57 (39.9)	2.5 (63.5)	4.17 (106)	1.13 (28.7)	1.57 (39.9)	1.13 (28.7)	VUBF - 96P - 9.52 VUBFD - 96P - 9.52
			3.3 (83.8)								VUBF - 96P - 12.7 VUBFD - 96P - 12.7
	1/2 in.										

1000 psig (68.9 bar) Compact Type (VUBFH-96P Type)

Features

1. Precision-formed metal bellows provides reliable seal to atmosphere.
2. Welded bonnet to body provides perfect seal to atmosphere.
3. A positive seal is repeatedly possible with nonrotating spherical disk.
4. Panel and bottom mounting.
5. End Connections: ∇^{R} - Lok 3.2, 6.35



Technical Data

Temperature and Pressure Rating

Size	3.2	6.35
Temperature °F (°C)	- 80 (- 62) ~ 600 (315)	
Working Pressure [psig (bar)]	1000 (68.9)	

Materials of Construction

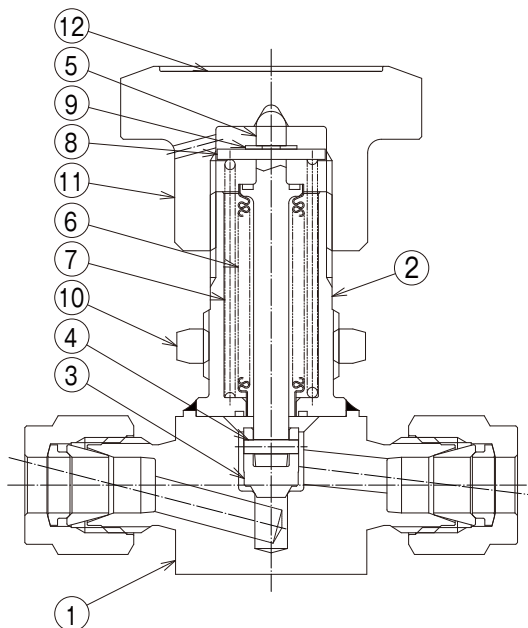

No.	Description	Materials	No.	Description	Materials
1	BODY ※	ASTM A479 316	7	SPRING	S17700
2	BONNET ※	ASTM A479 316	8	WASHER	ASTM A240 316
3	DISK ※	S17400	9	E - RING	S15700
4	STOP PIN ※	SUS304	10	PANEL NUT	ASTM A479 316
5	STEM ※	ASTM A479 316	11	HANDLE	A5056B
6	BELLOWS ※	ASTM A240 321	12	NAME PLATE	TETORON

※ : Wetted Parts

Dimensions and Ordering Numbers

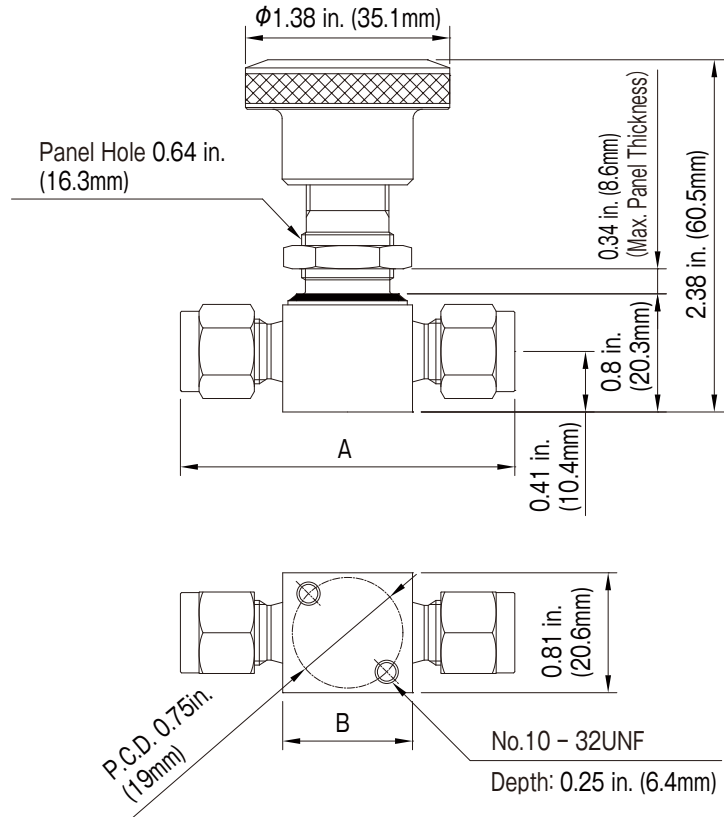

End Connection Inlet/Outlet	Size	Orifice in. (mm)	Dimensions in. (mm)		Ordering Numbers
			A	B	
 - Lok	1/8 in.	0.15 (3.8)	2.09 (53.1)	0.88 (22.3)	VUBFH - 96P - 3.2
	1/4 in.		2.27 (57.7)		VUBFH - 96P - 6.35

700 psig (48.2 bar) Metering Needle Bellows Valves (VUBFN-94MP Type)

Features

1. Minutes flow control type disk.
2. Micrometer handles provide precise flow control repeatedly.
3. Precision-formed metal bellows provides reliable seal to atmosphere.
4. Valves open to maximum flow in six turns.
5. Slotted handle tops enable adjustments with screwdriver.
6. Sealed between body and bellows by gaskets.
7. Panel and bottom mounting.
8. End Connection: ∇ ® - Lok 6.35



Technical Data

Temperature and Pressure Rating

Size	6.35
Temperature (°C)	- 20 (- 28) ~ 600 (315)
Working Pressure [psig(bar)]	700 (48.2)

Materials of Construction

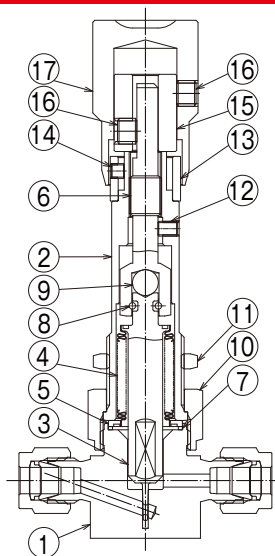

No.	Description	Materials	No.	Description	Materials
1	BODY ※	ASTM A479 316	10	BONNET NUT	ASTM A479 316
2	BONNET	ASTM A479 316	11	PANEL NUT	ASTM A276 316
3	DISK ※	ASTM A479 316	12	SET SCREW	ANSI 18.3 ALLOY STEEL
4	BELLOWS ※	ASTM A240 321	13	INDICATOR SCALE	ASTM A582 313
5	WELD RING ※	ASTM A479 316	14	SET SCREW	ANSI 18.3 ALLOY STEEL
6	STEM	ASTM A582 416	15	BUSH	ASTM A582 303
7	GASKET ※	ASTM A580 316	16	SET SCREW	ANSI 18.3 ALLOY STEEL
8	STOP PIN	SUS304	17	HANDLE	ASTM A582 313
9	BALL	SUS420C			

※ : Wetted Parts

Dimensions and Ordering Numbers

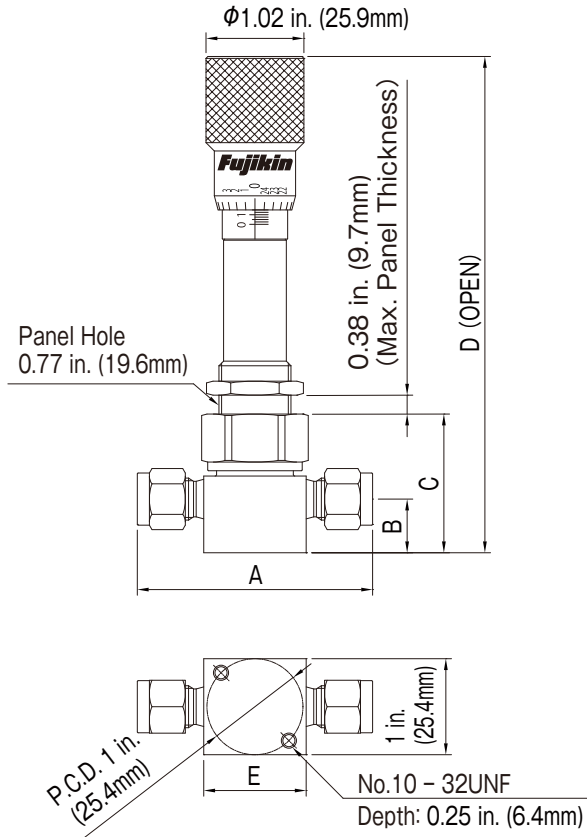

End Connections Inlet/Outlet	Size	Orifice in. (mm)	Dimensions in.(mm)					Ordering Numbers
			A	B	C	D	E	
 - Lok	1/4 in.	0.055 (1.4)	2.46 (62.5)	0.56 (14.2)	1.45 (36.8)	5.24 (133)	1.06 (26.9)	VUBFN - 94MP - 6.35

